

# Audio-Video Customer Stations



## Installation Instructions

1500 Series Customer Stations are available with 2-way audio and video capability for use indoors or out. The three series differ in screen size: 7 inches for the 1526, 10.4 inches for the 1527, and 15 inches for the 1529 (measured diagonally). They are housed in durable, powder-coated, steel enclosures and require 12 volt DC power from the included 5A power supply. The connection is made by a single Cat 5 cable to a 1500 Series hub or counter station. For assembly details visit: <https://www.audioauthority.com/page/cust-assy>.



MODEL 1526AV



MODEL 1527VB



MODEL 1529AVB

## Installing a Customer Station

The Model 1594 Mounting Arm is available to support the customer station from an adjacent surface, such as the side of a drive-up unit.

1. Remove the cap (one screw on each side) and the interior chassis assembly (four screws on front) from the enclosure. Remove the window and set it in a place where it will not get scratched.
2. Mount the 1594 mounting arm to the bottom of the customer station enclosure by removing four knockouts with a thin screwdriver and hammer and securing the arm at the desired angle using the supplied screws. Drill or punch three holes in the mounting surface and attach the mounting arm and customer station to it using the supplied screws, nuts, and clamp plate.
3. The customer station can be mounted directly to a flat surface by removing the appropriate knockouts from the back and screwing it to an electrical box or other surface using the supplied screws. Put the included self-sealing bushing in the wire knockout if the back will be exposed to rain. Puncture the self-sealing bushing to insert the wires. Insert the hub cable through the bushing before terminating it with an RJ45 connector



MODEL 1594

## Complete the Installation

1. Terminate the Category 5 or 6 hub cable with an RJ45 connector and plug it into the Hub port of the customer station chassis assembly.
2. Plug the 12-volt power supply into the vacant Power jack on the internal chassis assembly.
3. Fit the window onto the chassis assembly before sliding it back into the housing. *Note: For best weather gasket performance, evenly tighten the 4 chassis screws until snug.*
4. Apply power to the customer station and 1500 Series system. Test audio, video and call button performance and adjust settings using the Model 1550A Setup Tool as needed.
5. Set the screen brightness (backlight) as needed using the keys located on the back of the video monitor. Press the OSD key to bring up the On-Screen Display menu and press repeatedly to advance to the desired menu item. Use the Up and Down keys to adjust the backlight or other settings. Changes are saved automatically after a moment.
7. Reinstall the cap using two screws.

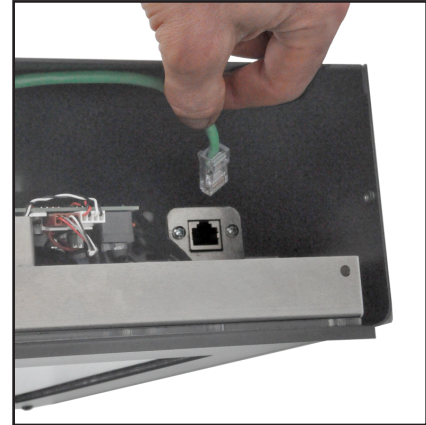

HUB PORT

Audio  Authority<sup>®</sup>

2048 Mercer Road, Lexington, KY 40511-1071 USA  
800-322-8346 • 859-233-4599 • Fax: 859-233-4510  
support@audioauthority.com • www.audioauthority.com

752-653B 20161118