

IMPORTANT: New Switch Design

The round product select button has undergone a design revision to improve durability in high-use environments.

Previous versions of the product select button used a “snap in” method of connecting the white plastic switch bracket to the black switch body. The new design features a bayonet-style connection method, similar to that found on BNC connectors.

IMPORTANT: New revision and old revision switch components are not compatible. Do not attempt to use differing parts together. The two components will not mate together – forcing the connection risks damage to the switch.

If you believe you have received incompatible switch brackets and switch bodies, contact Audio Authority Technical Support at 800-322-8346.

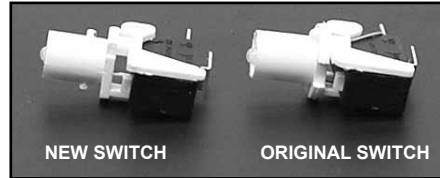

The new switch has locking posts.

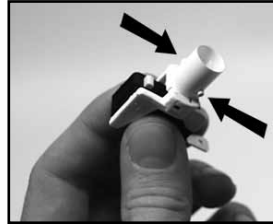

Two posts on the switch bracket must be aligned with the receptacles inside the switch body, pushed together, then twisted to lock into place.

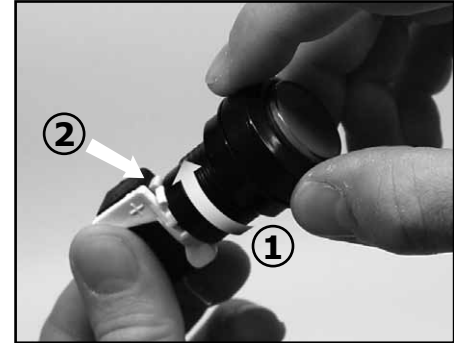

To mate switch parts, insert switch as shown and twist clockwise (1) so that push button foot meets the switch actuator (2).

To remove the switch mechanism from switch body, turn a few degrees counter clockwise, and pull apart.

Audio  Authority®

2048 Mercer Road, Lexington, Kentucky 40511-1071
Phone: 859-233-4599 • Fax: 859-233-4510
Customer Toll-Free USA & Canada: 800-322-8346
Website: www.audioauthority.com

752-599
12/09